

Compact Design Cooling Element Model: MDS2

Applications

- Cooling elements are used when the medium temperature would exceed the permissible temperature limit of the pressure measuring instrument.
- Dissipates elevated live steam temperature
- Rugged design for direct mounting
- Process industry: Chemical/petro chemical, power stations, food and beverage, offshore oil rigs, pulp and paper, environmental technology, machine building and general plant construction

Special features

- For medium temperatures up to 200°C
- All stainless steel 316L
- Pressure ranges up to 1000 bar

Description

- **Body material** Stainless steel 316L
Hastelloy, Monel, Tantalum(option)
- **Process connection** Stainless steel 316L
¼ NPT, ½ NPT, BSP (option)



Dimensions in mm

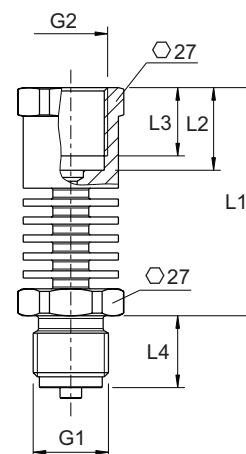
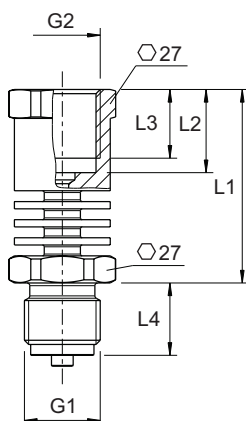

G1	G2	L1	L2	L3	L4
G ½ B (EN 837)	G ½ B female (EN 837)	53.5	23	19	20

G1	G2	L1	L2	L3	L4
G ½ B (EN 837)	G ½ B female (EN 837)	63.5	23	19	20

Characteristic curve at ambient temperature 20°C

For 3 cooling fins

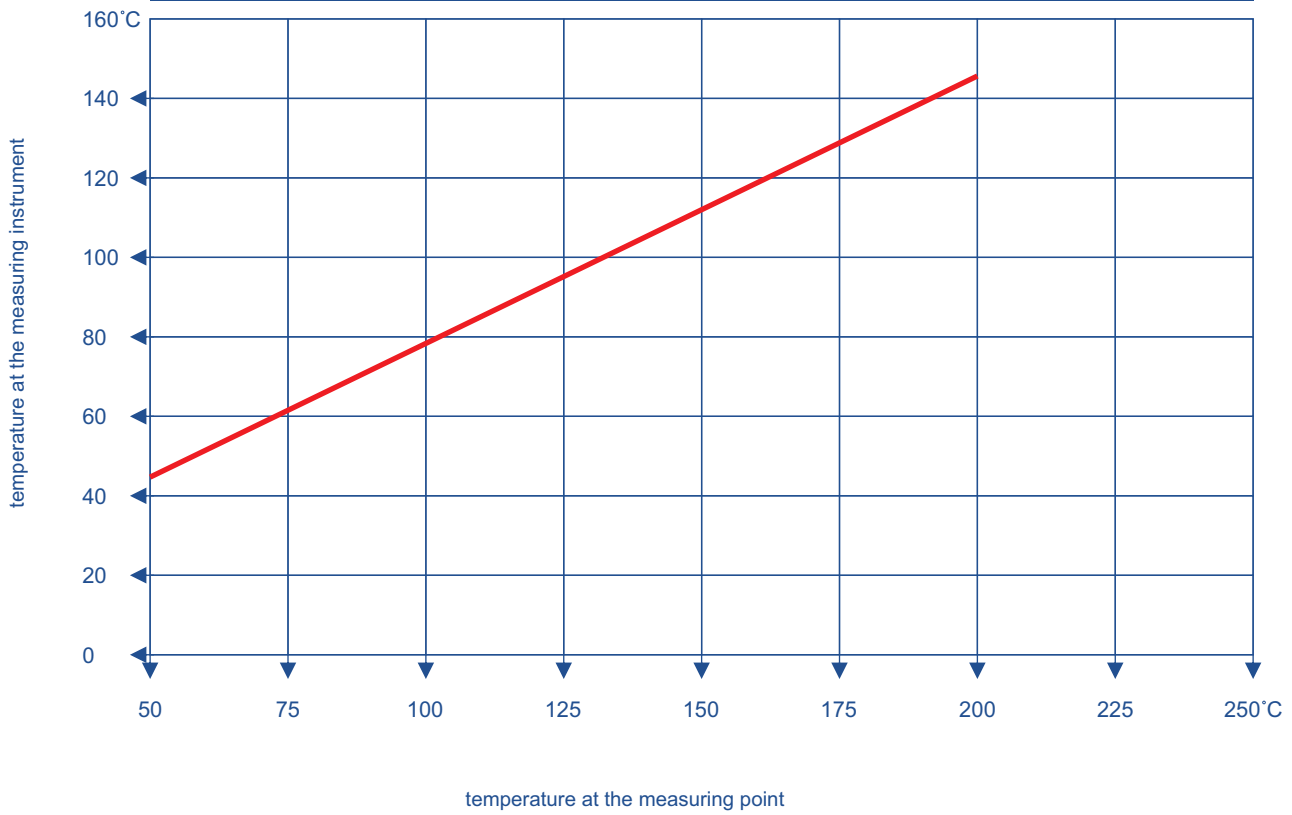

Characteristic curve at ambient temperature 20°C

For 5 cooling fins

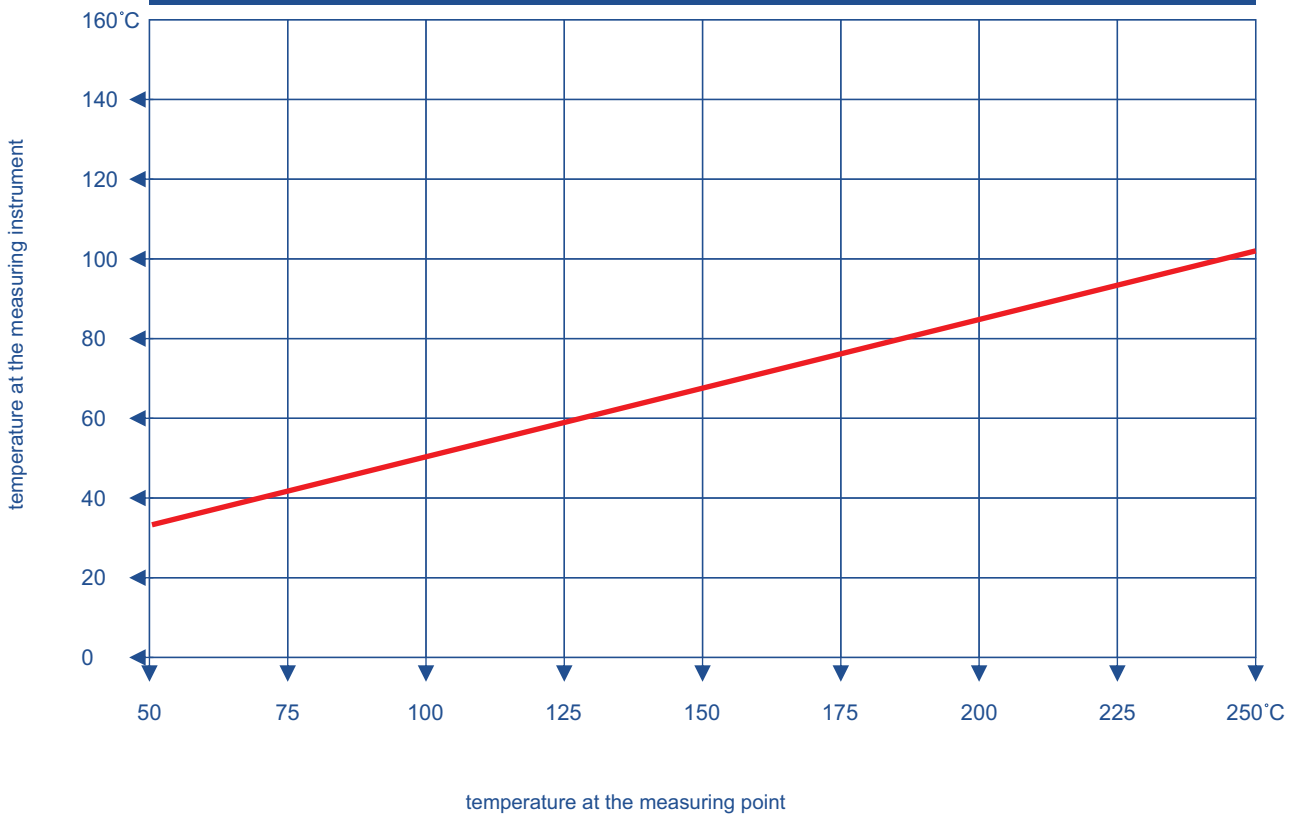

MDS2 Compact Design Cooling Element

ORDERING CODE	Example:	MDS2	4	M	5	OS	Note
Process Connection Sizes							
2 - ¼ NPT							
4 - ½ NPT			4				
6 - ¾ G							
8 - 1½ G							
10 - Customer							
Body material							
B - Brass							
S - 316L Stainless steel							
M - Monel® 400				M			
H - Hastelloy							
C - Customer							
Shape							
3 - 3 cooling fins							
5 - 5 cooling fins					5		
C - Customer							
Options							
OS - Overload stop						OS	
NS - According to NACE MR 0175 & NACE MR 0103 standard							
Other sealing							





Address: 7191 Yonge street, Toronto, Canada

Tel: +16472221281(5 line)

Web: www.madecotech.com

Email: Info@madecotech.com